

1 Plug the RJ11 cable directly into your corded phone's **Headset socket**.
The headset socket is usually on the underside of the base and labeled either **Headset** or with a headset icon like this

1 Plug in

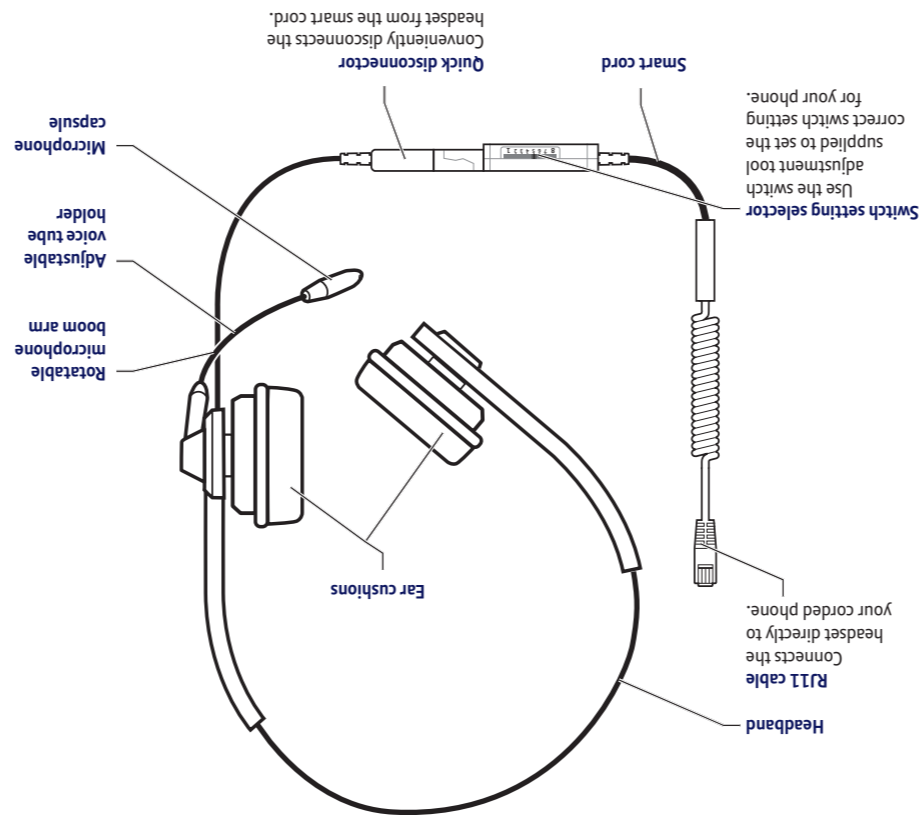

Your headset

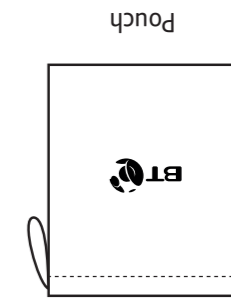

Headset with smart cord attached

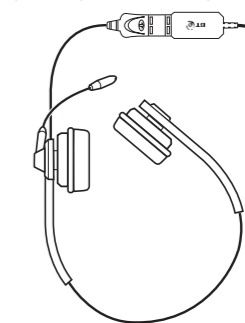

Check box content:

Switch adjustment tool



User Guide

- 1 Plug in
- 2 Select switch setting
- 3 Wearing your headset

BT Corded Headset H41

Setting up is easy. Just follow the simple steps in this guide.

If you'd like further help, please visit our website bt.com/producthelp or call our helpdesk on 0808 100 6996*.

* Calls made from within the UK mainland network are free. Mobile and international call costs may vary.

General information

Guarantee

Your BT Corded Headset H41 is guaranteed for a period of 2 years from the date of purchase.

Subject to the terms listed below, the guarantee will provide for the repair of, or at BT's or its agent's discretion the option to replace the BT Corded Headset H41, or any component thereof, which is identified as faulty or below standard, or as a result of inferior workmanship or materials. Products over 28 days old from the date of purchase may be replaced with a refurbished or repaired product.

The conditions of this guarantee are:

- The guarantee shall only apply to defects that occur within the 2 year guarantee period.
- Proof of purchase is required.
- The equipment is returned to BT or its agent as instructed.

This guarantee does not cover any faults or defects caused by accidents, misuse, fair wear and tear, neglect, tampering with the equipment, or any attempt at adjustment or repair other than through approved agents.

This guarantee does not affect your statutory rights.

To find out what to do if your headset is in or outside of the 2 year guarantee, go to bt.com/producthelp

How to recycle your equipment

The symbol shown here and on the product means that the product is classed as electrical or electronic equipment, so DO NOT put it in your normal rubbish bin.

It's all part of the Waste Electrical and Electronic Equipment (WEEE) Directive to recycle products in the best way – to be kinder to the planet, get rid of dangerous things more safely and bury less rubbish in the ground.

You should contact your retailer or supplier for advice on how to dispose of this product in an environmentally friendly way.

R&TTE Directive & Declaration of Conformity

This product is intended for use within the UK for connection to the public telephone network and compatible switchboards.

This equipment complies with the essential requirements for the Radio Equipment and Telecommunications Terminal Equipment Directive (1999/5/EC).

For a copy of the Declaration of Conformity please refer to bt.com/producthelp

For a Better Future

We're always looking to make our products last longer and use less power, so we don't have such a big impact on the environment.

To find out about what we are doing, visit bt.com/betterfuture

Offices worldwide

The services described in this publication are subject to availability and may be modified from time to time. Services and equipment are supplied subject to British Telecommunications plc's respective standard conditions of contract. Nothing in this publication forms any part of a contract.

© British Telecommunications plc 2013.
Registered Office: 81 Newgate Street, London EC1A 7AJ.
Registered in England No. 1800000.

Designed and produced by The Art & Design Partnership Ltd.

Printed in China / Issue 2 / ADP07-13



2 Select switch setting

- 1 You need to set the correct switch setting for your phone. Refer to the table below to find the correct switch setting for your phone.

Position	Used On Telephone	Amplified Microphone	Pin Wiring
1	Standard (most common), Converse 2200 / 2300 & Paragon 550/650	No	M-, R, R, M+
2	Cisco IP phones 79xx series	No	R, M-, M+, R
3	Ascom office & Philips phones	No	R, M+, M-, R
4	Japanese phones, NEC, Nitsuko	No	M+, R, R, M-
5	Plantronics Vista Base	No	R, R, M+, M-
6	Panasonic phones with modular plug	Yes	M+, R, R, M-
7	Nortel digital phones & Avaya IP phones	Yes	M-, R, R, M+
8	Avaya Callmaster V & VI, Cisco IP phones 79xx series	Yes	R, M-, M+, R

- 2 Use the switch adjustment tool to set the correct setting. Place the tool into the groove and gently slide the switch to the correct number setting.

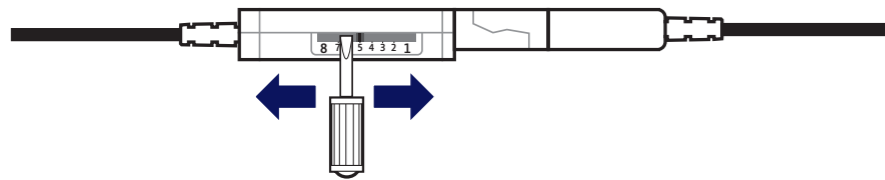

Amplified Microphone - this setting is only applicable to phones with built-in microphone volume control.

3 Wearing your headset

Position the headset

Place the headband over the top of your head with one ear cushion over each ear. You can wear the headset microphone on either the left or right ear, simply rotate the microphone boom arm as shown in 'Position the microphone'.

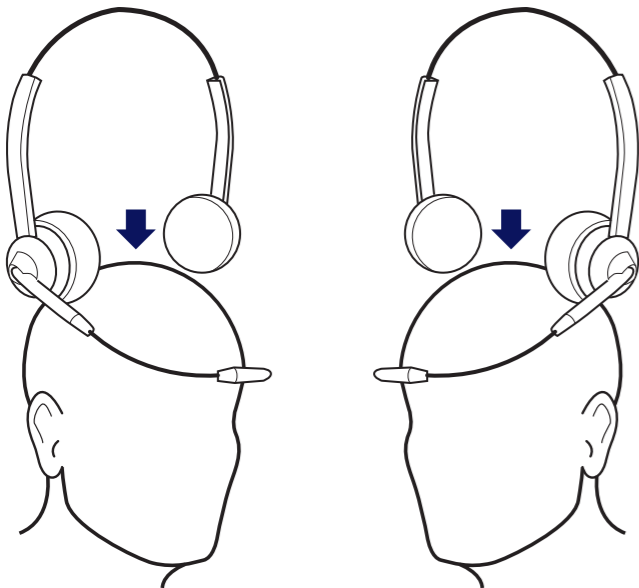

Adjust the headband length

Push up or pull down the top section of the headband until it fits comfortably on your head.



Position the microphone

- 1 Adjust the microphone by rotating the microphone boom as shown, until the microphone capsule is at a comfortable distance from your mouth.
- 2 The voice tube holder can be extended or shortened so you can adjust the distance the microphone capsule is from your mouth.

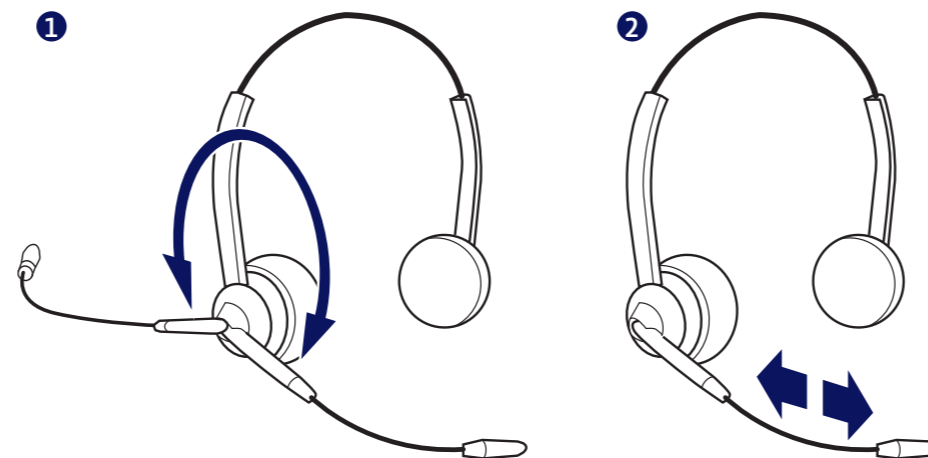

- 3 To achieve the best sound quality, the microphone capsule should be positioned at a comfortable distance from your mouth so your voice is heard clearly by your caller.

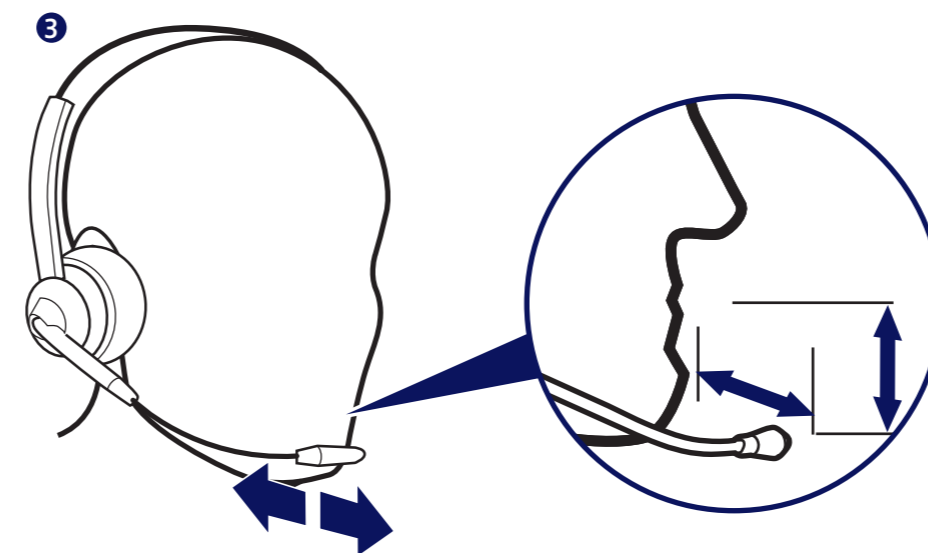

Using the quick disconnecter

The quick disconnecter conveniently allows you to disconnect the headset from the smart cord so you don't have to take your headset off when you want to leave your desk for short periods.

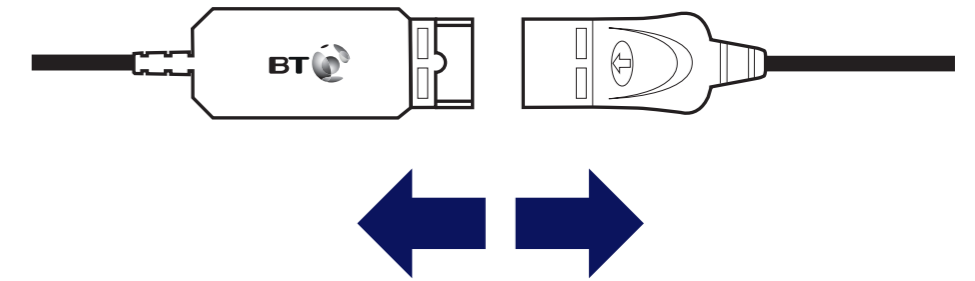

To reconnect the headset, simply clip the disconnecter back together until it makes a slight clicking sound.

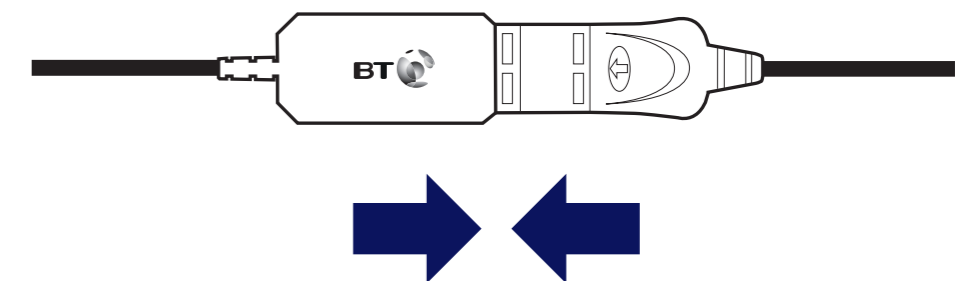

If you need more help, go to bt.com/producthelp or call 0808 100 6996*.